



**WUDWARE**

*Designed in italy*

[wudwarestore@gmail.com](mailto:wudwarestore@gmail.com)

[www.wudware.in](http://www.wudware.in)



Welcome to WUDWARE, your one-stop-shop for all your home decor needs. We are a leading online store that offers a wide range of high-quality and affordable home decor products. Our collection includes everything from furniture to lighting, rugs, curtains, and more. We believe that your home should reflect your personality and style, which is why we offer a diverse range of products to suit every taste and budget. Our team of experts is dedicated to providing you with exceptional customer service and ensuring that you have a seamless shopping experience. At WUDWARE, we are committed to sustainability and source our products from eco-friendly and socially responsible manufacturers. Shop with us today and transform your home into a beautiful and comfortable space that you'll love coming back to.

[www.wudware.in](http://www.wudware.in)

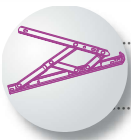

# WINDOW, DOOR & GLASS HARDWARE

**01** FRICTION STAY - HI LOAD (SS304)



**04** CONCEALED CORNER HINGE 80 / 120 (WITH BEVELLED GROOVE)

Load Capacity: 80/120 kg.  
Shutter Width: 4ft (1220mm)  
Shutter Height: 8ft (2438mm)  
Stack Height: 21mm



**05** WINDOW HANDLE - HEAVY (L/R)



**08** MORTISE WINDOW HANDLE -3



**06** ALUMINIUM WINDOW HANDLE - DELUXE 2



**09** WINDOW-DOOR HANDLE WITH PUSH LATCH



**07** MORTISE WINDOW HANDLE WITH LOCK 3



**01** - Size: 8" (205mm) 10" (255mm) , 12" (305mm), 14" (355mm), 16" (405mm), 20" (510mm), 24" (610mm), 28" (710mm). **02** - Size : 10" (250mm), 12" (300mm), 14" (350mm). **03** - Size : 20" (500mm), 24" (600mm), 28" (700mm). **04** - Load : 80/120 Kgs. **05** - Finish: White/ Black **06** - Finish: White/Black. **07** - Finish: White/ Black. **08** - Finish: White/Black. **09** - Finish: White/ Black.

## FEATURES

- Made of AISI 304 stainless steel.
- Pressure adjustable brake for stopping.
- Can be used for side hung horizontal axis opening ventilators, as well as top hung vertical axis opening windows.
- Self cleaning design.
- Max. opening angle: 90°
- Stack Height - 15mm (for 8" to 14") 18mm (for 16" to 28")
- Applicable in wooden, UPVC or aluminium windows.
- Also available in independent left and right hand working for better closing and alignment.
- Load capacity: 13-50Kg

**02** FRICTION STAY 1319 (SS304)



Load Capacity:  
10" (250mm) - 18kg,  
12" (300mm) - 22kg,  
14" (350mm)- 25kg  
Stack Height: 19mm.  
Max. Opening Angle: 88°

**03** FRICTION STAY HEAVY DUTY (SS304)



Load Capacity: 80 kg.  
Stack Height: 16.5mm  
Max. Opening Angle:  
25° (for 20")  
20° (for 24" & 28")

#### TRANSMISSION LOCK STRIP FOR SWING DOORS



- Available in three lengths (600,1000,1600mm) with two & four locking points.
- Can be used for both left & right hand locking windows.
- Compatible with Ebco Mortise Window Handle with Lock (AWH-DML3/AWH-DM3)

#### TRANSMISSION LOCK STRIP FOR SLIDING DOORS

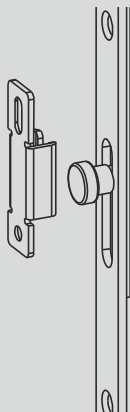

- Available in three lengths (600,1000,1600mm) with two & four locking points.
- Can be used for both left & right hand locking windows.
- Compatible with Ebco Mortise Window Handle with Lock (AWH-DML3/AWH-DM3)

#### 10 WINDOW HANDLE (LOW / LOW 4-HOLE)



#### 11 WINDOW HANDLE - EURO



#### 12 EURO WINDOW HANDLE - 4 HOLE



#### 13 CRESCENT LATCH



#### 14 SLIDING WINDOW LOCK 1925



#### 15 SLIDING WINDOW LATCH



#### 16 SLIDING WINDOW LATCH - CLICK FIT

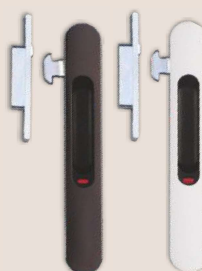

#### 17 SLIDING WINDOW LATCH - CLICK FIT LONG



#### 18 SLIDING WINDOW LATCH - EASY



#### SLIDING WINDOW LATCH CATCHES



SWL2-C



SWL3-D



SWL4-C



SWL5-CP



SWL6-CPH



SWLC-F

#### 19 ALUMINIUM DOOR HANDLE



#### CONNECTOR ROPE FITTING



#### 20 ALUMINIUM CORNER CLEAT



10 - Finish: Brown/Black/Window White/Silver/White Matt/ Champagne Gold. 11- Finish: Brown/Black/Window White/Silver/White Matt. 12 - Finish: Brown/Black/Window White/Silver/White Matt. 13 - Finish: Brown/Black/Window White/Silver. 14 - Finish: (with key) White/ Brown/Grey/Black, (manual) White/Brown/Black. 15 - Finish: Brown/ Black/Window White/Silver/Champagne Gold. 16 - Finish: Window White/Black/ Champagne/Brown. 17 - Finish: Window White/ Black/ Champagne/ Brown. 18 - Finish: Brown/Black/Window White/ Silver/ Champagne Gold. 19 - Finish: White/Black. 20 - Size: Big-36mm x 48mm thk. Small-22mm x 10.4mm thk.



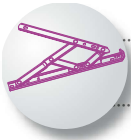

# WINDOW, DOOR & GLASS HARDWARE

## SLIDING DOOR FITTING (125KGS)



SLIDING DOOR FITTINGS -  
STANDARD



SLIDING DOOR FITTINGS -  
FLUSH



SLIDING DOOR FITTINGS -  
GLASS



Load capacity:  
40, 80 & 120kgs  
Finish: Black / Grey

SOFT CLOSE KIT  
FOR SDF 125

## SLIDING DOOR SYSTEM 100 – SOFT CLOSE (FOR WOODEN / AL. FRAME & GLASS DOOR)



### FEATURES

- Designed for Wooden, Al. Frame and Glass Door.
- High precise roller, stable, smooth & silent sliding.
- Easy to install and remove.
- Door Width : 580 -1200mm
- Door Weight : ≤80Kgs
- Door Thickness : 35-50mm (For Wooden & Al. Frame Door)  
8-12mm ( For Glass Door)

Top mounting rail

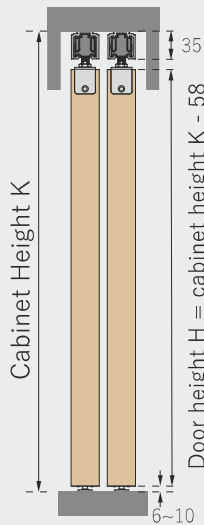

Wooden Door

Top mounting rail

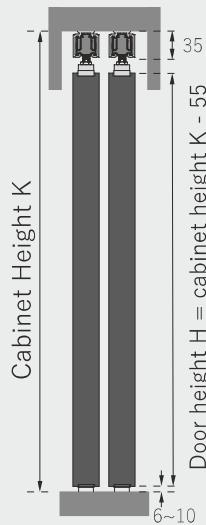

Al. Frame Door

Top mounting rail



Glass Door

## LINKED SLIDING PARTITION SYSTEM 100 – SOFT CLOSE (FOR WOODEN & AL. FRAME DOOR)



### FEATURES

- Designed for Wooden & Al. Frame Doors.
- High precise roller, stable, smooth & silent sliding.
- Easy to install and remove.
- Door Width : 580 -1200mm (single) and 820 -1200mm (double)
- Door Weight : ≤80Kgs
- Door Thickness : 35-50mm

2+1 Door

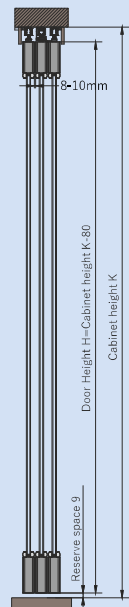

Wooden Door

3+1 Door

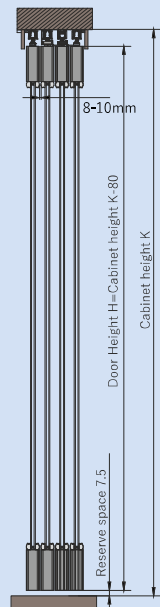

2+1 Door

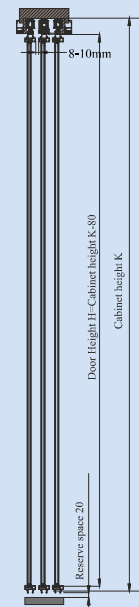

Al. Frame Door

3+1 Door

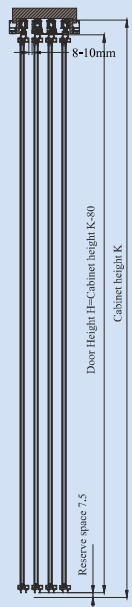

## 2 WAY SYNCRO SLIDING PARTITION SYSTEM 100 – SOFT CLOSE (FOR WOODEN & AL. FRAME DOOR)



### FEATURES

- Designed for Wooden & Al. Frame Partition Doors which can be opened & closed synchronously.
- High precise roller, stable, smooth & silent sliding.
- Easy to install and remove.
- Door Width : 580 - 1200mm (single) and 820 -1200mm (double)
- Door Weight : ≤80Kgs
- Door Thickness : 35-50mm

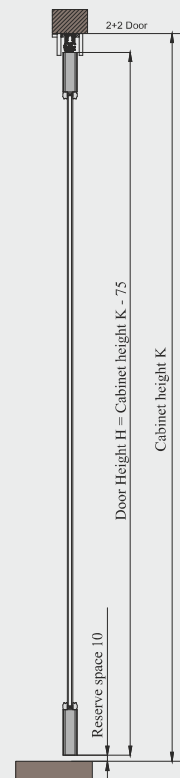

Wooden Door

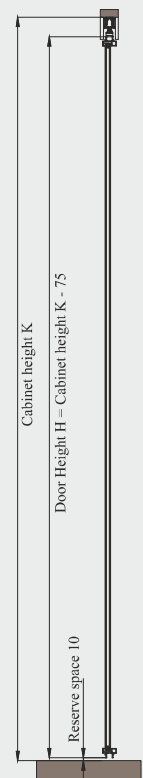

Al. Frame Door

### WOOD SLIDING FOLDING FITTING

Min. Door Thickness: 40mm  
Load capacity: 60kgs/panel

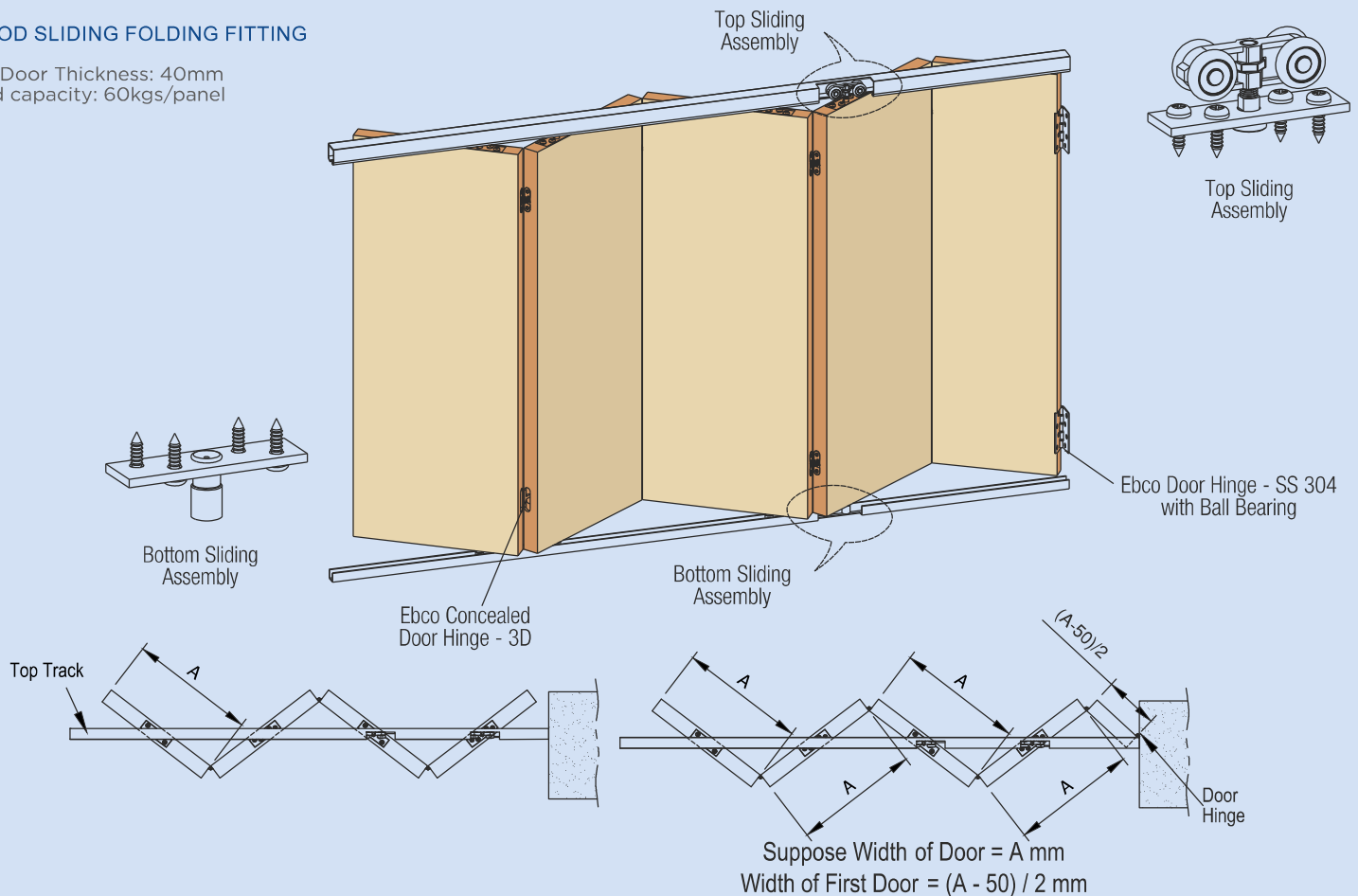

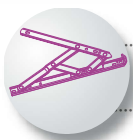

## WINDOW, DOOR & GLASS HARDWARE

### PRESTO - DOOR KNOB LOCK **PRESTO**



Anthracite

#### Available Finish



Nickel Satin



Antique Brass



Brushed Steel



Chrome Plated

#### BORING KIT FOR PRESTO LOCK



Size : 23mm & 42mm

#### SLIDING DOOR LOCK - WOOD, SWING DOOR LOCK - WOOD / ALUMINIUM.



Sliding Door Lock



Swing Door Lock



Opening Tool



**TO OPEN:**  
SIMPLY PRESS DOWN  
ON THE TOP CAP



**TO CLOSE:**  
LET GO OF THE TOP CAP

#### DOOR HINGES - SS 304 (WITH 2 BALL BEARING)



- Made out of SS304, the hinges are designed with precision ball bearings.
- Size: 75x75x2.0mm  
125x75x2.5/3.0mm  
100x75x2.5/3.0mm

#### BUTT HINGES SS 304 – WELDED (W/O BEARING)



- Made out of SS 304
- Suitable for doors of different sizes and weight.
- Available Sizes : 4 x 12", 5 x 12", 3 x 12"
- Available with screws.

#### CONCEALED HINGE - 3D

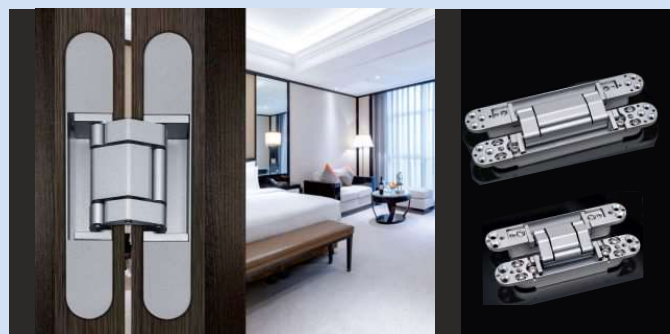

- Ideal for flush wooden door applications.
- 3-dimensional adjustment function allows vertical, horizontal and depth adjustment after hinge is installed.
- 300,000 cycles tested.
- Cover hides all screw for aesthetic looks.
- For 3D, Max. Door Weight, Min Door Thickness (T) & Width (W): For 40Kgs - 35mm (T) & 850mm (W), For 80Kgs - 40mm (T) & 1000mm (W), For 120Kgs - 45mm (T) & 1400mm (W). Max. Opening Angle: 180°.



## SECURITY DOOR LATCH

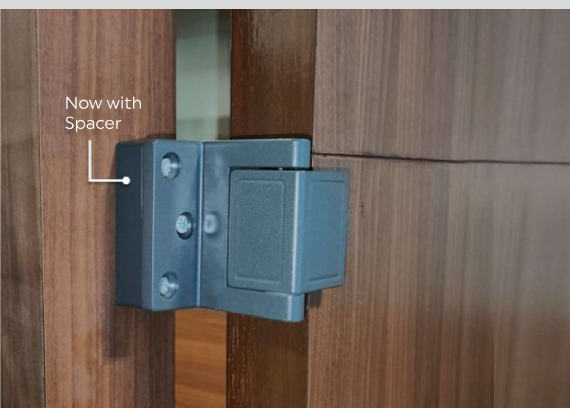

- For Main doors: apartments, villas & hotels.
- Open or block the door with easy to flip turn designed Security door latch.
- Only attaches to the door frame, no fitting on the door
- Comes with packing (optional) for thick doors.
- Minimum frame width: 38mm
- Finish: Brown/Anthracite/Transparent Gold

## DOOR VIEWER



- This door viewer gives ultra clear view with 165° wide angle.
- Door Thickness : 25 - 60mm
- Drill Hole : Ø25mm
- Finish : Brushed Steel and Antique.

## DOOR OPENER BRACKET

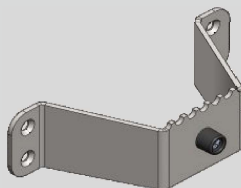

- Ebco Door Opener Bracket is an ideal solution, which eliminates the use of hand to open the door. Ideal for offices, hospitals, retail outlets, etc.
- Prevents contamination and spread of germs/viruses.
- Wall bumper to protect the wall from damage.
- Curved tooth design ensures better grip.
- To be used in commercial latch-less doors.

## DOOR LATCH -SS 304



## TURN LATCH



## DOOR CLOSERS



**21** - DC 101 Door Width : 850 mm. Door Weight : 65 kgs. Type : Hold Open. Opening Angle : 180°. DC 101-B2 Door Width : 800 mm. Door Weight : 45 kgs. Type : Non Hold Open. Opening Angle : 180°. **22** - DC 201 Door Width : 1050mm. Door Weight : 85 kgs. Type : Hold Open. Opening Angle : 180°. DC 201-B Door Width : 900mm. Door Weight : 65 kgs. Type : Non Hold Open. Opening Angle : 180°. DC 201-C Door Width : 1050mm. Door Weight : 85 kgs. Type : Without Hold Open. Opening Angle : 180°.

### 21 DOOR CLOSER - DC 101 DOOR CLOSER - DC 101-B2



5,00,000  
CYCLE TESTED



### 22 DOOR CLOSER - DC 201 DOOR CLOSER - DC 201-B DOOR CLOSER - DC 201-C

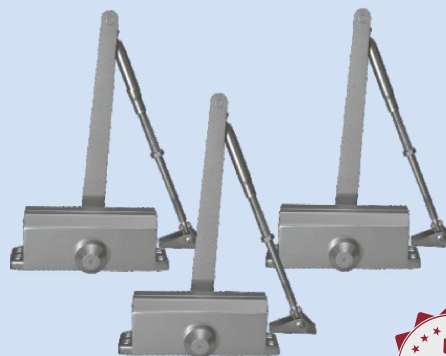

5,00,000  
CYCLE TESTED

DC 201-C



DC 201



DC 201-C



DC 201-B

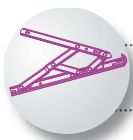

## WINDOW, DOOR & GLASS HARDWARE

### 23 DOOR CLOSER - DC 301 DOOR CLOSER - DC 301-B



5,00,000  
CYCLE TESTED

### 24 DOOR CLOSER - PELMET ARM



3,00,000  
CYCLE TESTED

### 25 DOOR CLOSER - DC 1001

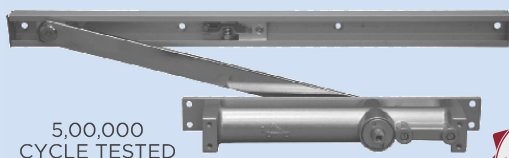

5,00,000  
CYCLE TESTED



### 26 DOOR CLOSER - DC 1002



5,00,000  
CYCLE TESTED



**23** - DC 301 Door Width : 1200mm. Door Weight : 105 kgs. Type : Hold Open. Opening Angle : 180°. DC 301-B Door Width : 1200mm. Door Weight : 105 kgs. Type : Non Hold Open. Opening Angle : 180°. **24** - Door Width : 500 - 1000mm. Door Load Capacity: 30 - 80 kgs. Type : Hold Open. Opening Angle : 130°. **25** - Door Width : Up to 850mm. Door Weight : 65 kgs. Type : Hold Open. Opening Angle : 180°. **26** - Door Width : Up to 1000mm. Door Weight : 85 kgs. Type : Hold Open. Opening Angle : 150°.

## FLOOR SPRING & ACCESSORIES



### FLOOR SPRING - 84

- 20,00,000 cycle tested
- Universal Application - Load Adjustment From: 80kg - 100kg (For DFS 84-100C model) and 100kg - 130kg (For DFS 84-130C model)
- Max. Door Width: 900-1000mm (For DFS 84-100) and 1000-1100mm (For DFS 84-130).
- Max. Opening Angle - 130°
- 90° Hold Open Angle



DFS 84-100C



DFS 84-130C



### FLOOR SPRING - 75V

- 20,00,000 cycle tested
- Universal application - Load adjustment from 60 to 150 kg
- Door Width - 1100mm
- Max opening angle - 360°
- Hold Open angle at 90° and at any point between - 105° to -105°



## 27 FLOOR SPRING - 60



## 28 FLOOR SPRING - 90



## 29 FLOOR SPRING - 250



### FLOOR SPRING DOOR ACCESSORIES (DFS-A1)

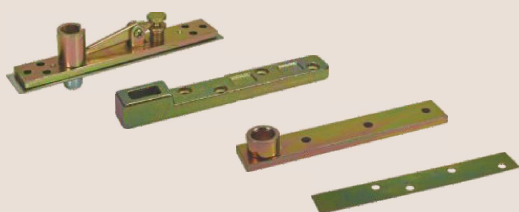

### FLOOR SPRING DOOR ACCESSORIES (DFS-A2)



## 30 BOTTOM PIVOT (DPF4-01)



## 31 TOP PIVOT (DPF4-02)



### PATCH FITTINGS (SS 304)

Glass Thickness: 10 - 12mm  
Finish: Brushed Steel

#### BOTTOM CORNER PATCH

DPF1-01



#### TOP CORNER PATCH

DPF1-02



#### CORNER 'L' PATCH WITH PIVOT

DPF1-04



#### CENTRE LOCK

DPF2-01



#### STRIKE PATCH FOR CENTRE LOCK

DPF2-02



#### SINGLE CONNECTOR PATCH

DPF3-01



### CORNER 'L' PATCH WITHOUT PIVOT

DPF3-02



### PATCH FITTINGS

Finish: Brushed Steel

### OVER PANEL PATCH WITH PLATE

DPF1-03



### QUAD CONNECTOR PATCH

DPF3-03



### DOUBLE CORNER PATCH

DPF3-04



## 32 AUTO CLOSING PATCH

DACP1-100



**27** - 5,00,000 cycle tested. Max. open angle : 116°. Hold open angle: 90° Max. Door Width : 700mm. Max. Door Weight: 60 kgs. **28** - 5,00,000 cycle tested. Max. open angle : 116°. Hold open angle: 90° Max. Door Width : 800-1000mm. Max. Door Weight : 90 kgs. **29** - 5,00,000 cycle tested. Door Width : 1200mm. Max. open angle : 130°. Hold open angle: 90°. Max. Door Weight : 250 kgs. **30** - To be used directly on the floor without floor spring. **31** - Top receiver pivot for wooden or ceiling installation. **32** - Max. open angle : 360°. Hold open angle: 90° Max. Door Width : 1100mm. Max. Door Weight: 100 kgs.



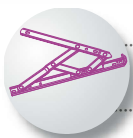

## WINDOW, DOOR & GLASS HARDWARE

### GLASS CONNECTORS (SS 304)

Glass Thickness: 8 - 12mm  
Finish: Brushed Steel/ Polished SS

90° WALL TO GLASS OR  
FLOOR TO GLASS CONNECTOR



90° WALL TO GLASS  
CONNECTOR



90° GLASS TO GLASS  
CONNECTOR

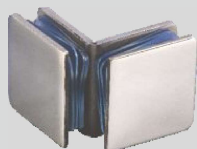

135° WALL TO GLASS  
CONNECTOR



135° GLASS TO GLASS  
CONNECTOR



180° WALL TO GLASS  
CONNECTOR



180° GLASS TO  
GLASS CONNECTOR

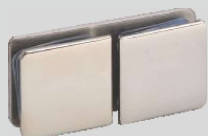

3 WAY GLASS TO  
GLASS CONNECTOR



### SHOWER HINGES (SS 304)

Glass Thickness: 8 - 12mm  
Max. Load: 54kgs.  
Finish: Brushed Steel/ Polished SS

SHOWER HINGE 90°  
(WALL TO GLASS) - T TYPE



SHOWER HINGE 90°  
(WALL TO GLASS) - L TYPE



SHOWER HINGE 135°  
GLASS TO GLASS



SHOWER HINGE 180°  
GLASS TO GLASS



SHOWER HINGE 90°  
GLASS TO GLASS



### GLASS DOOR LOCKS (SS 304)

Finish: Brushed Steel  
Glass Thickness: 10mm -12mm

OPENABLE GLASS DOOR LOCK -  
GLASS TO WOOD - SS304



OPENABLE GLASS DOOR LOCK -  
GLASS TO GLASS - SS304



OPENABLE GLASS DOOR  
LOCK - GLASS TO GLASS -  
SS304 - KNOB



SLIDING GLASS DOOR LOCK -  
GLASS TO WOOD - SS304



SLIDING GLASS DOOR LOCK -  
GLASS TO GLASS - SS304



### GLASS DOOR HANDLES (SS 304)

Finish: Brushed Steel

#### 33 DOOR HANDLE - D



#### 34 DOOR HANDLE - H



33 Sizes ØDia(mm)		Hole to hole ØDistance(mm)
Ø19mm	X	250mm
Ø22mm	X	300mm
Ø25mm	X	450mm
Ø32mm	X	600mm

34 Sizes ØDia(mm)		Hole to hole ØDistance(mm)
Ø22mm	X	150mm
Ø25mm	X	200mm
Ø25mm	X	300mm
Ø32mm	X	450mm
Ø32mm	X	750mm

## GLASS SLIDING FOLDING SYSTEM 2 (SS 304)



Max. Door Width: 800mm  
Max. Door Height: 2000mm  
Max. Door Weight: 60kgs each  
Finish: Brushed Steel

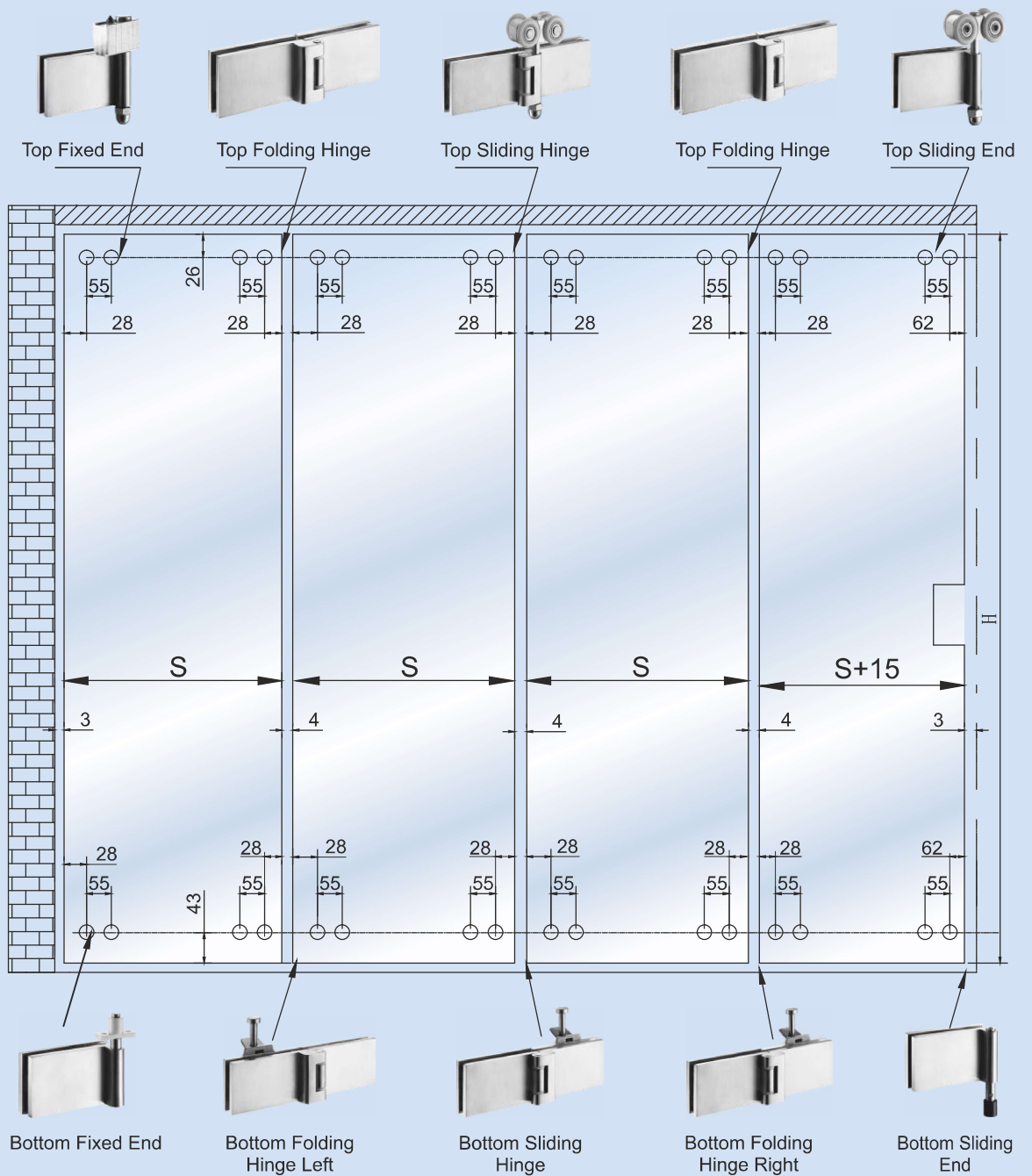

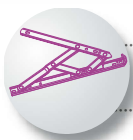

## WINDOW, DOOR & GLASS HARDWARE

### SHOWER SLIDING FITTINGS - RECTANGULAR

- Made out of SS304
- Max. load - 60kgs.
- Suitable for 8mm to 10mm glass thickness .
- Max. installation length 2 mtrs.
- Glass to be toughened after making the holes.



### SHOWER FITTINGS Finish: Brushed Steel/SSS/ Polished SS

WALL TO TUBE  
CONNECTOR -  
19MM



TUBE TO GLASS  
CONNECTOR -  
19MM



TUBE TO TUBE  
CONNECTOR -  
19MM

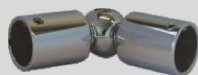

SHOWER ROD  
Ø 32 X 24



SHOWER  
DOOR  
KNOB



DOOR HANDLE -  
DIA 19MM X 150MM X  
450MM



DOOR  
STOPPER



### PLASTIC SEALS

35

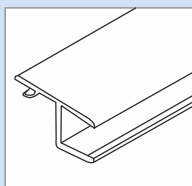

PVC SEAL  
BPS1-10

36

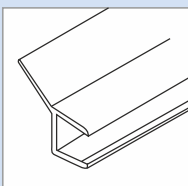

PVC SEAL  
BPS2-12mm

37

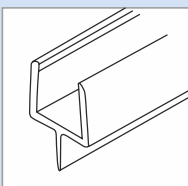

BOTTOM PVC SEAL  
BPS3-08/12mm

38

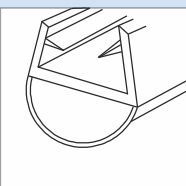

PVC SEAL  
BPS7-S08/S12mm

39

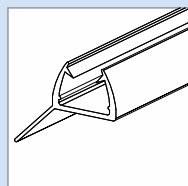

PVC SEAL  
PS2-10/12

40

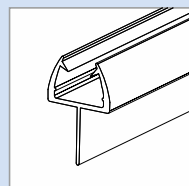

BOTTOM PVC SEAL  
PS3-12

41

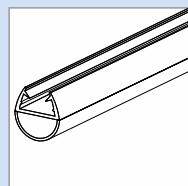

PVC SEAL  
PS7-S10/S12

### SLIDING GLASS DOOR HANDLE

42

SLIDING GLASS DOOR  
HANDLE - SS304



SGD1 BS/PS

43

SLIDING GLASS DOOR  
HANDLE - ALUMINIUM

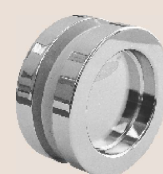

SGD2 AP



SGD3 AP

35 - Glass Thickness: 10mm (BPS1-10mm). 36 - Glass Thickness: 12mm (BPS2-12mm). 37 - Glass Thickness: 8 & 12mm (BPS3-08/12). 38 - Glass Thickness: 8 & 12mm (BPS7-08/12). 39 - Glass Thickness: 10 & 12mm (PS2-10/12). 40 - Glass Thickness: 12mm (PS3-12). 41 - Glass Thickness: 10 & 12mm (PS7-S10/S12). 42 - Glass Thickness: 8-12mm. Finish: Brushed Steel/SSS/Polished SS. 43 - Glass Thickness: 8-12mm. Finish: Aluminium Polished.